



## Electric Construction Property Site Sketch and Liability Waiver

Customer Name: \_\_\_\_\_

Service Address: \_\_\_\_\_ City, State, Zip \_\_\_\_\_

### Location Of Customer-Owned Facilities

All above ground and underground facilities must be clearly identified on your Property Site Sketch below.

**Customer is required to indicate all that apply on the Property Site Sketch — see included EXAMPLE on Page 2.**

- |  |   |  |   |
|--|---|--|---|
| <ul style="list-style-type: none"> <li>• Desired electric meter location <u>with footages</u> from nearest corner of the building (Indicate E).</li> <li>• External wood furnaces and associated buried heating lines</li> <li>• Geothermal heat pumps with connecting lines to buildings</li> </ul> | <ul style="list-style-type: none"> <li>• Wells and private water lines including underground sprinkler systems with connecting lines to buildings.</li> <li>• Drain tile/buried down spout and sump pump lines</li> <li>• Planned or potential deck, patio, swimming pools or outbuildings</li> </ul> | <ul style="list-style-type: none"> <li>• Municipal sewer/water laterals</li> <li>• Septic systems/drain fields with connecting lines to buildings</li> <li>• Air conditioning units and all fresh air intakes</li> <li>• Existing and future landscaping features<br/>IE : Landscape berms or retaining walls</li> </ul> | <ul style="list-style-type: none"> <li>• LP fuel lines/tanks with connecting lines to buildings</li> <li>• Invisible Fences</li> <li>• Private underground wiring</li> <li>• Private cable/satellite TV Lines</li> <li>• Other</li> </ul> |
|--|---|--|---|

If no existing or future proposed private facilities on the property check here



**At the time of construction, all existing or proposed private underground facilities must be marked or exposed before service can be installed.**

### Construction Authorization / Underground Damage Liability Waiver:

I certify that I own or am the authorized representative of the owner of the property of the service address indicated on this Property Site sketch, and that I have read and understood the above statement regarding marking and / or exposing all private underground facilities. I furthermore agree to hold Marquette Board of Light and Power and/or its agents harmless for any damage to private underground facilities that occurs during the installation of gas or electric service as a result of failure on my part to ensure that the private underground facilities on this property have been adequately marked and / or exposed.

Signature: \_\_\_\_\_ Date: \_\_\_\_/\_\_\_\_/\_\_\_\_ 1

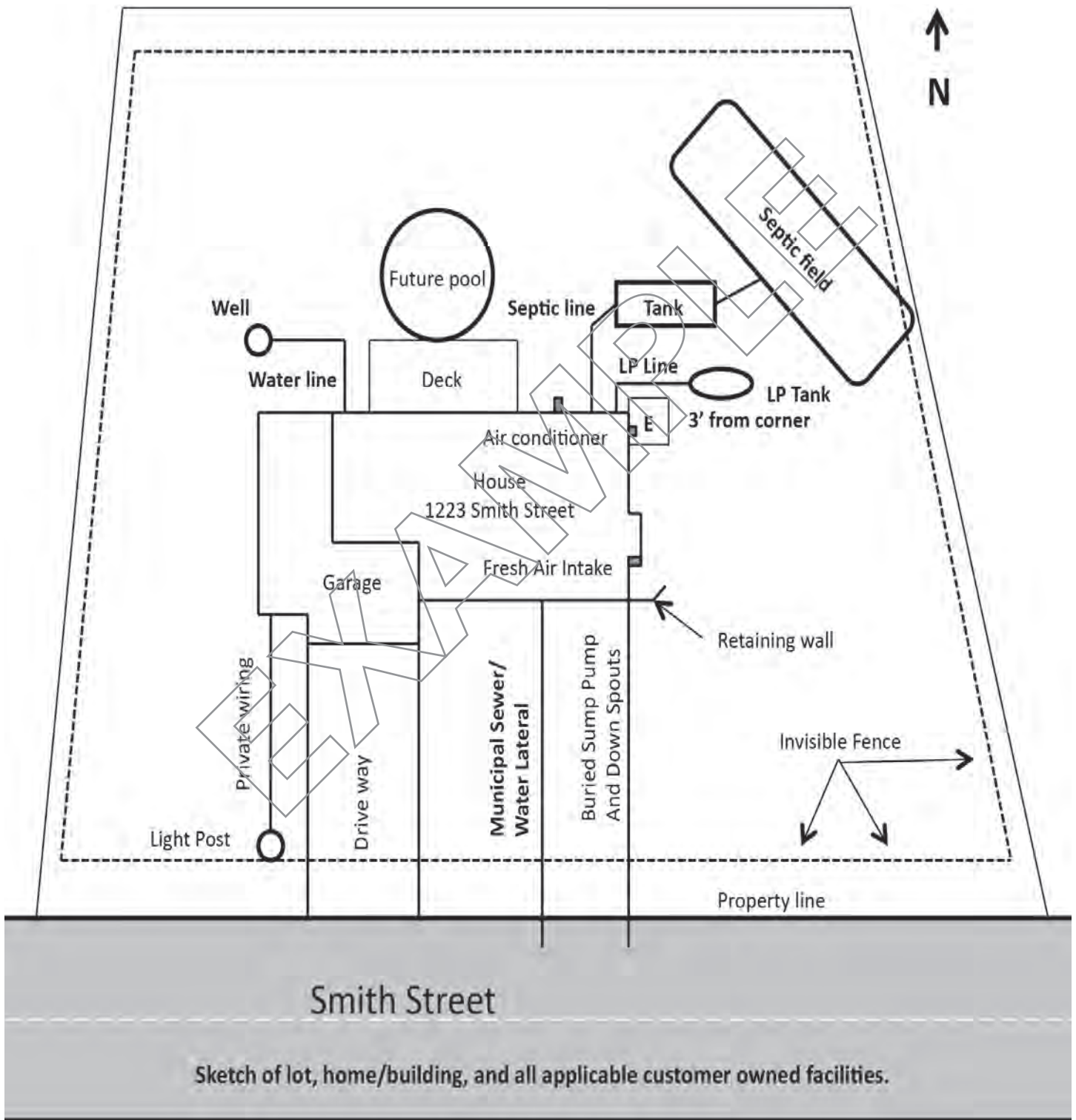

Please complete and return this form to:

Marquette Board of Light and Power • Distribution Engineering Dept. • 2200 Wright Street, Marquette, MI 49855

Meter Department: Phone: 906-228-0303 • Fax: 906-228-0329 • Email: [kdowns@mblp.org](mailto:kdowns@mblp.org)

Engineering Department Phone: 906-228-0323 • Fax: 906-228-0329 • Email: [sseibert@mblp.org](mailto:sseibert@mblp.org)

Website: [www.mblp.org](http://www.mblp.org)