



Residential Electric Service Application

Complete application and Site Sketch and Liability Waiver form

TYPE OF SERVICE REQUESTED: *check all that apply*

- New Service Upgrade Relocate
 Electric Temporary Electric

TODAY'S DATE:

PARTY RESPONSIBLE FOR CONSTRUCTION CHARGES:

(If contractor, contact the utility to transfer service to customer)

Customer Contractor

PARTY SUBMITTING THIS REQUEST:

Customer Contractor

CONTACT PERSON:

(Complete applicable information below)

Customer Contractor

CUSTOMER INFORMATION:

Legal Name: _____ *Home #: _____ *Cell #: _____

Mailing Address: _____

Street/P.O. Box City State Zip Code

E-mail Address: _____

Current Street Address: _____

Same as mailing address Street City State Zip Code

CONTRACTOR INFORMATION:

Legal Name: _____ *Work #: _____ *Cell #: _____

Mailing Address: _____ Contact Name: _____

Street/P.O. Box City State Zip Code

E-mail Address: _____

SITE INFORMATION:

Building, House, Fire #: _____

Street: _____ Lot #: _____ County: _____

Town/City/Village: _____ State: _____ Zip Code: _____

Directions from Nearest Intersection: _____

STRUCTURE INFORMATION

Construction Type: Single Family Mobile Home Duplex Modular Other: _____

Usage: Year-Round Use Seasonal Use

Bldg. square footage: _____

ELECTRIC INFORMATION:

Electrical Contractor: _____ Entrance Size 100 200 400 Other: _____

Primary Contact: _____ Meter Location if Overhead: _____

Contact #: _____

Service

Overhead

Underground – You are responsible to contact communication providers.

Welder Compressor

Temporary Service Yes No

There is a charge for Temporary Service.

If yes, date site will be ready for service: _____

HEATING INFORMATION:

Electric

Gas/Propane

Geothermal

Wood

PRESENT STATUS OF BUILDING PROJECT: (check all that apply)

Property is staked Yes *If not, when?* _____ Site has been excavated Yes *If not, when?* _____

Building is staked Yes *If not, when?* _____ Meter base installed Yes *If not, when?* _____

SERVICE READY DATE: (date that initiates scheduling of service installation)

Date Site will be Ready for Service: _____

PLEASE NOTE: The following requirements must be completed before service can be installed.

- Site sketch waiver must be received.
- Foundation must be backfilled and within 6" of final grade.
- Service route cleared 10' wide of brush, etc.
- The electric meter base must be installed.
- Easements need to be signed and on file.
- Some construction charges are to be paid in advance.

Other Important Details:

It's important to contact the utility if there are changes to your site.

- When we are notified that your site is ready, service installation typically begins within 10 business days. After the electric is installed and your Electrical Inspection is received, the meter is typically set and energized within 3-5 business days. This time line is dependent on the complexity of your job, weather, road restrictions, and crew availability.

Return to: Marquette Board of Light and Power
Attention: Distribution Engineering

- Email: sseibert@mblp.org
- Fax: 906-228-0329
- Mail: 2200 Wright Street,
Marquette, MI 49855

Questions: Call 906-228-0323 or visit our website at www.mblp.org



Electric Construction Property Site Sketch and Liability Waiver

Customer Name: _____

Service Address: _____ City, State, Zip _____

Location Of Customer-Owned Facilities

All above ground and underground facilities must be clearly identified on your Property Site Sketch below.

Customer is required to indicate all that apply on the Property Site Sketch — see included EXAMPLE on Page 2.

- | | | | |
|--|---|--|---|
| <ul style="list-style-type: none"> • Desired electric meter location <u>with footages</u> from nearest corner of the building (Indicate E). • External wood furnaces and associated buried heating lines • Geothermal heat pumps with connecting lines to buildings | <ul style="list-style-type: none"> • Wells and private water lines including underground sprinkler systems with connecting lines to buildings. • Drain tile/buried down spout and sump pump lines • Planned or potential deck, patio, swimming pools or outbuildings | <ul style="list-style-type: none"> • Municipal sewer/water laterals • Septic systems/drain fields with connecting lines to buildings • Air conditioning units and all fresh air intakes • Existing and future landscaping features
IE : Landscape berms or retaining walls | <ul style="list-style-type: none"> • LP fuel lines/tanks with connecting lines to buildings • Invisible Fences • Private underground wiring • Private cable/satellite TV Lines • Other |
|--|---|--|---|

If no existing or future proposed private facilities on the property check here



At the time of construction, all existing or proposed private underground facilities must be marked or exposed before service can be installed.

Construction Authorization / Underground Damage Liability Waiver:

I certify that I own or am the authorized representative of the owner of the property of the service address indicated on this Property Site sketch, and that I have read and understood the above statement regarding marking and / or exposing all private underground facilities. I furthermore agree to hold Marquette Board of Light and Power and/or its agents harmless for any damage to private underground facilities that occurs during the installation of gas or electric service as a result of failure on my part to ensure that the private underground facilities on this property have been adequately marked and / or exposed.

Signature: _____ Date: ____/____/____

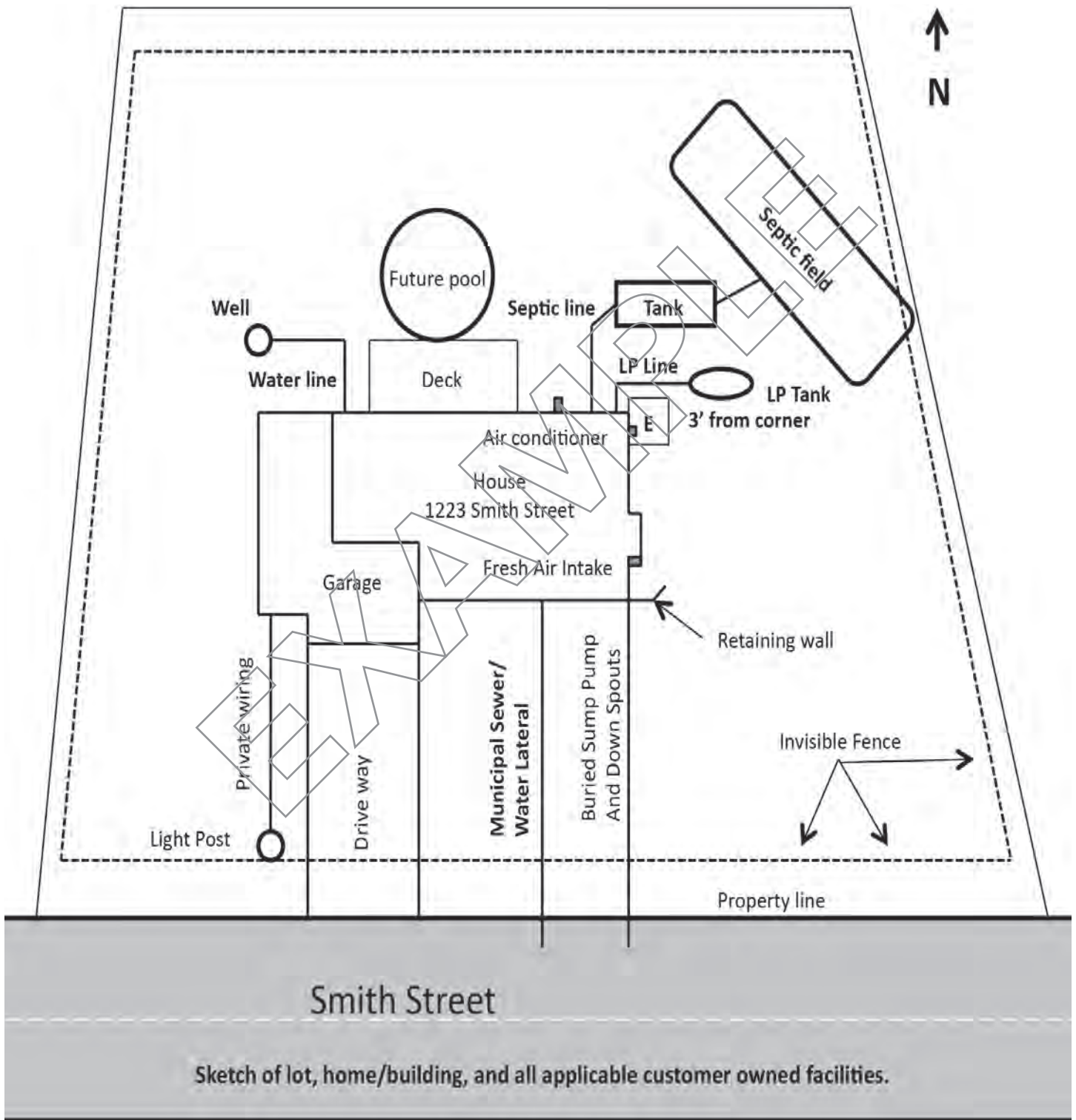

Please complete and return this form to:

Marquette Board of Light and Power • Distribution Engineering Dept. • 2200 Wright Street, Marquette, MI 49855

Meter Department: Phone: 906-228-0303 • Fax: 906-228-0329 • Email: kdowns@mblp.org

Engineering Department Phone: 906-228-0323 • Fax: 906-228-0329 • Email: sseibert@mblp.org

Website: www.mblp.org